

1965-66 FRONT END SHEET METAL — TYPICAL

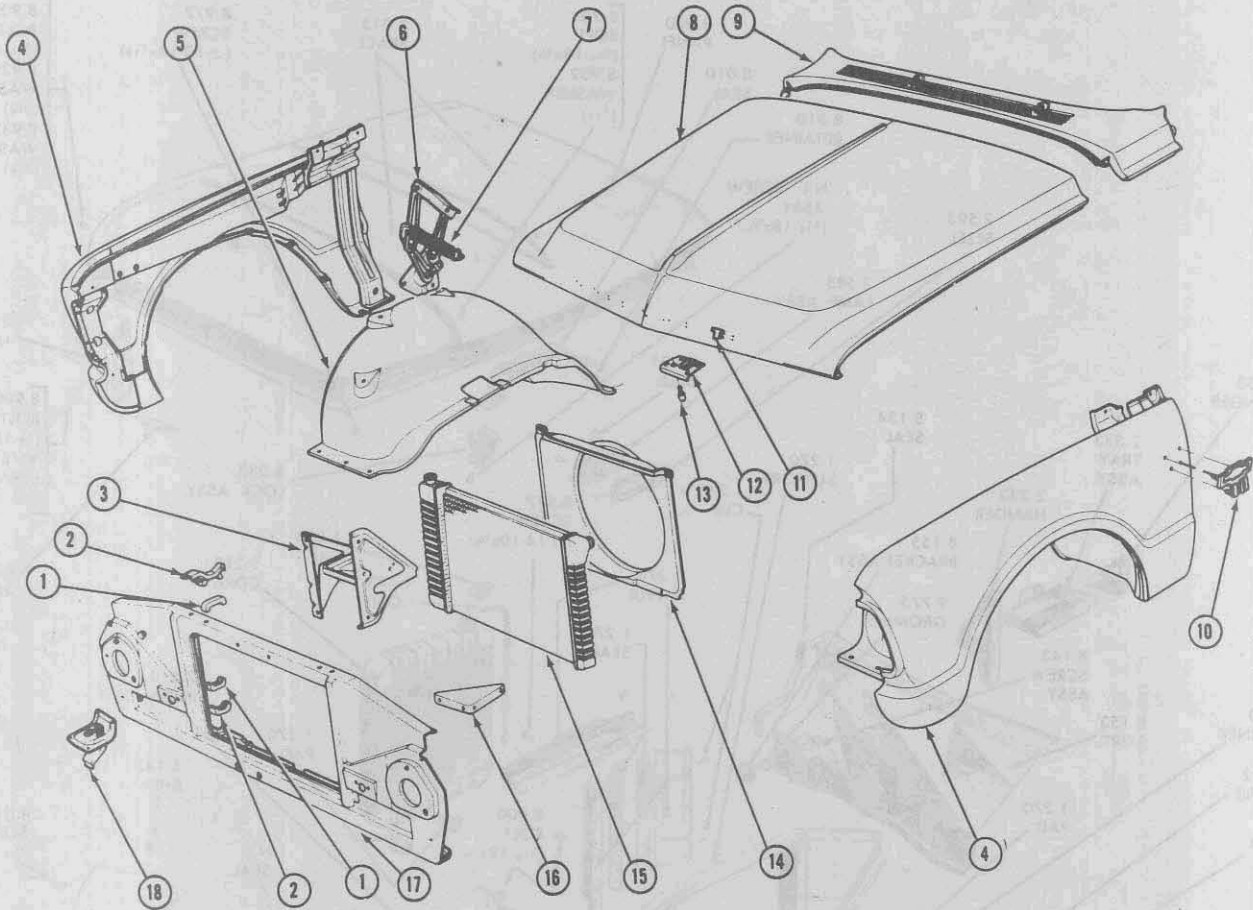

1967-68 SERIES 10-20-30 FRONT SHEET METAL — EXPLODED (TYPICAL)

Key	Description	Group
1	PAD, Radiator Retainer	1.270
2	RETAINER, Radiator—Upper	1.270
	RETAINER, Radiator—Lower	1.270
3	TRAY, Battery	2.333
4	FENDER, Front	8.130
5	SKIRT, Front Fender	8.153
6	HINGE, Hood	8.015
7	SPRING, Hood Hinge	8.013
8	PANEL, Hood	8.000
9	GRILLE ASSY., Cowl Top Ventilator	16.125

Key	Description	Group
10	PLATE, Series Designation	8.147
11	LETTER, Front End Panel	8.055
12	SUPPORT, Hood Locking Bolt	8.080
13	BOLT, Hood Lock	8.085
14	SHROUD, Radiator Fan	1.277
15	RADIATOR ASSY	1.219
16	GUSSET, Radiator	1.270
17	SUPPORT, Radiator	1.270
18	CATCH ASSY., Hood Lock	8.083

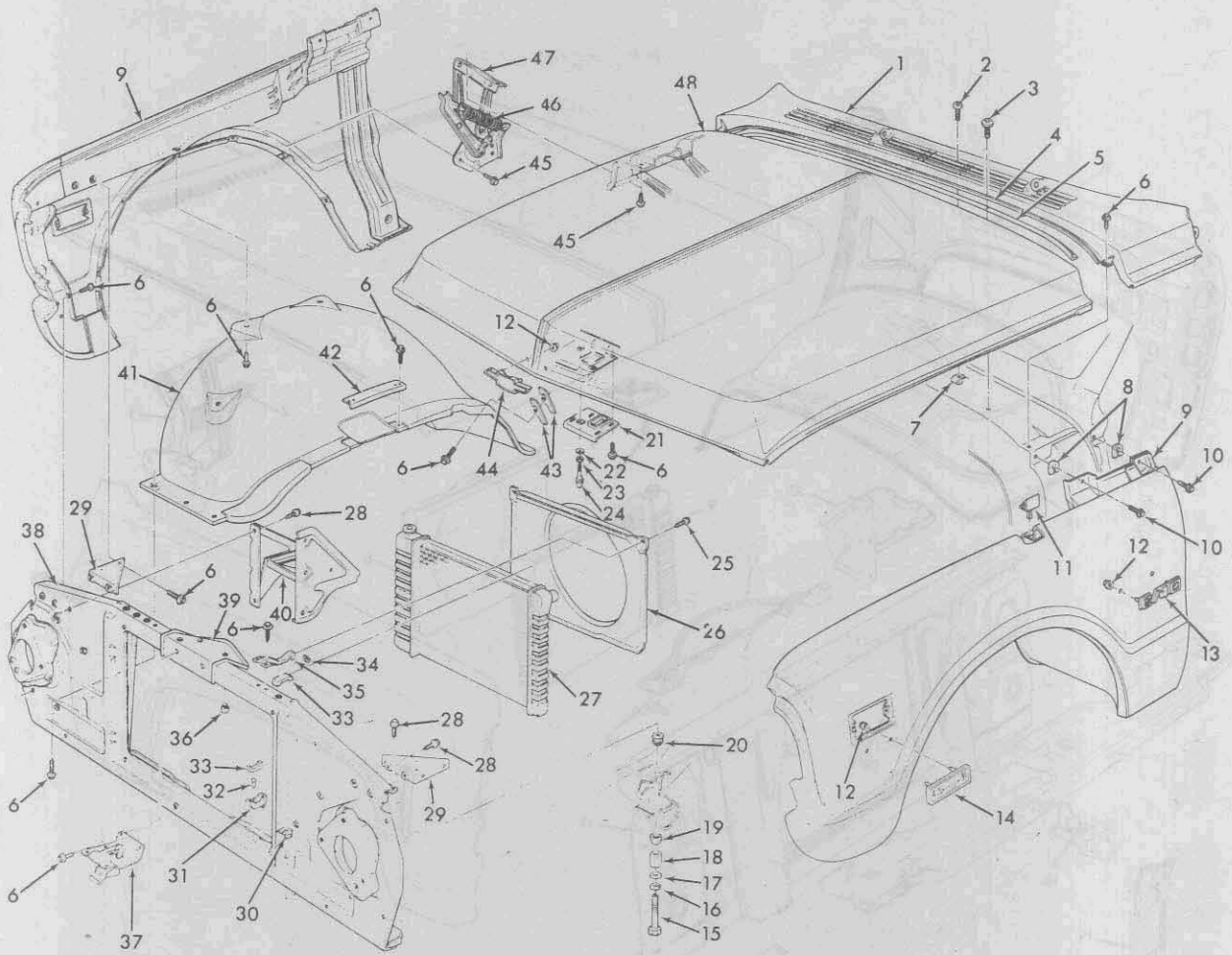

1969-72 FRONT END SHEET METAL — EXPLODED (TYPICAL)

Key	Description	Group
1	GRILLE, Cowl Top Ventilator	16.125
2	SCREW #10-16 x 1/2	8.977
3	SCREW #10-16 x 5/8	8.977
4	RETAINER, Cowl Hood Ledge Seal	8.154
5	SEAL, Cowl Hood Ledge	8.010
6	BOLT, Hex. HD 3/16-18 x 7/8	8.900
7	NUT, J-Type #10-16	8.921
8	SHIM, Front Fender	8.130
9	FENDER, Front	8.130
10	BOLT, Hex. HD 3/8-16 x 1 1/8	8.900
11	BUMPER, Hood Panel Side	8.024
12	NUT, Hex. Lock	8.917
13	PLATE, Series Designation	8.147
14	PLATE, Front Fender Side Name	8.147
15	BOLT, Hex. HD 3/16-14 x 2 3/4	8.900
16	WASHER, Lock	8.931
17	WASHER, Radiator Support Mounting	1.270
18	SPACER, Radiator Support Mounting Cushion	1.270
19	CUSHION, Radiator—Lower	1.270
20	RADIATOR, Radiator—Upper	1.270
21	SUPPORT, Hood Locking Bolt	8.080
22	WASHER, Lock 1/2	8.932
23	NUT, Hex. 1/2-20	8.916
24	BOLT, Hood Lock	8.085

Key	Description	Group
25	BOLT, Hex. HD 3/8-16 x 3/4	8.900
26	SHROUD, Radiator Fan	1.277
27	RADIATOR ASSEMBLY	1.219
28	BOLT, Hex. HD 3/16-18 x 3/4	8.900
29	GUSSET, Radiator Support	1.270
30	NUT, 1/4-14	8.915
31	RETAINER, Radiator—Lower	1.270
32	RIVET, 3/16 x 3/16 x 3/16 OL	8.967
33	PAD, Radiator Retainer	1.270
34	NUT, 'J' Type	8.921
35	RETAINER, Radiator—Upper	1.270
36	BUMPER, Radiator Fan Guard	1.064
37	CATCH ASSEMBLY, Hood Lock	8.083
38	SUPPORT, Radiator	1.270
39	GUARD, Radiator Fan	1.064
40	TRAY, Battery	2.333
41	SKIRT, Front Fender	8.153
42	REINFORCEMENT, Front Fender Skirt	8.155
43	SHIM, Front Fender Skirt	8.153
44	EMBLEM, Hood	8.055
45	BOLT, Hex. HD 3/8-16 x 7/8	8.900
46	SPRING, Hood Hinge	8.013
47	HINGE, Hood	8.015
48	PANEL, Hood	8.000

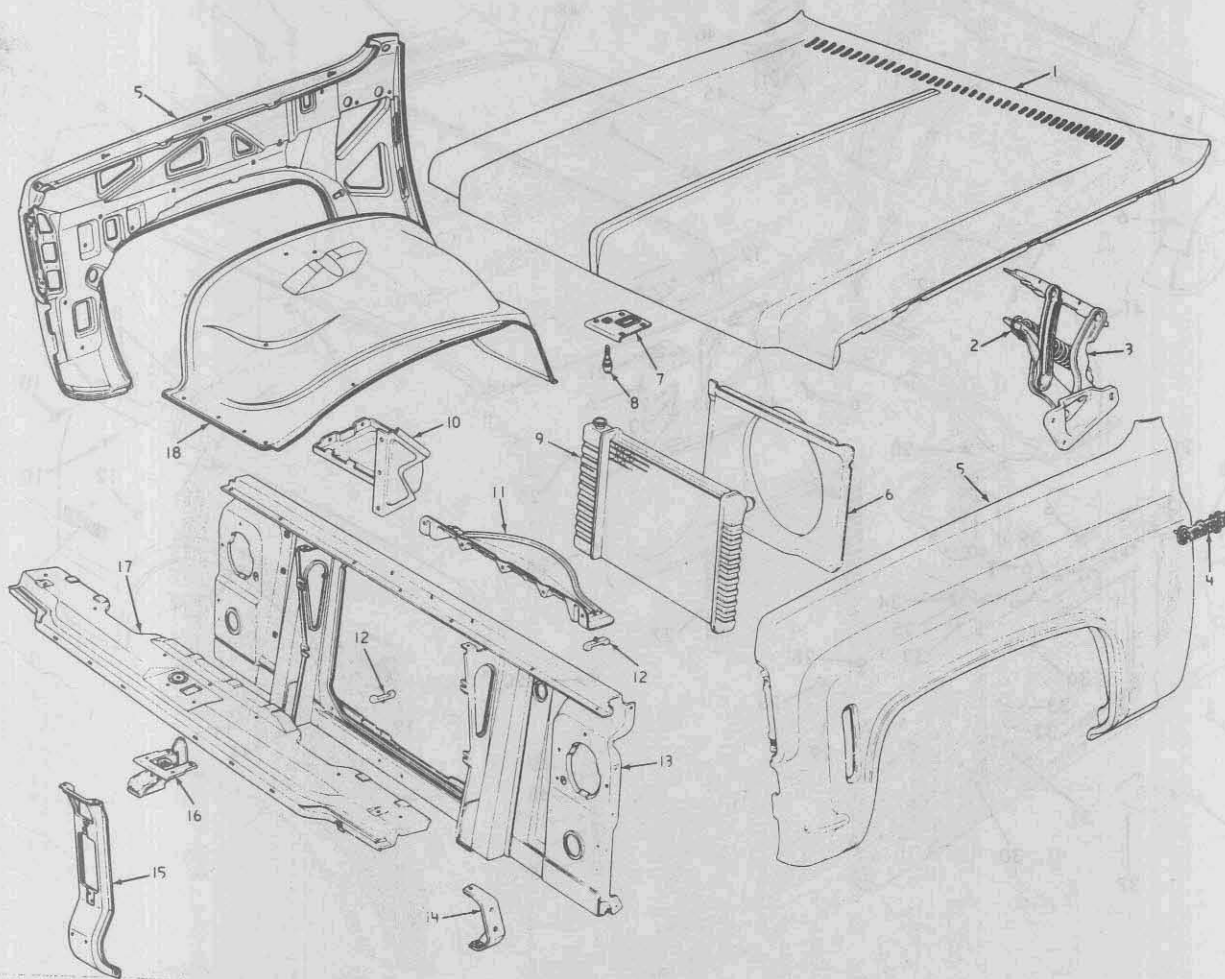

1973-75 C-K MODELS FRONT END SHEET METAL

Key	Description	Group
1	Panel, Hood	8.000
2	Spring, Hood Hinge	8.013
3	Hinge, Hood	8.015
4	Plate, Series Designation	8.147
5	Fender, Front	8.130
6	Shroud, Radiator Fan	1.277
7	Support, Hood Lock Locking Bolt	8.080
8	Bolt, Hood Lock	8.085
9	Radiator Assembly	1.219

Key	Description	Group
10	Tray, Battery	2.333
11	Panel, Radiator Mounting	1.270
12	Pad, Radiator Retainer	1.270
13	Support, Radiator	1.270
14	Support, Radiator Grille Lower Panel	1.266
15	Support, Hood Lock Catch	8.080
16	Catch Assembly, Hood Lock	8.083
17	Panel, Radiator Baffle Upper Grille	1.287
18	Skirt, Front Fender	8.153

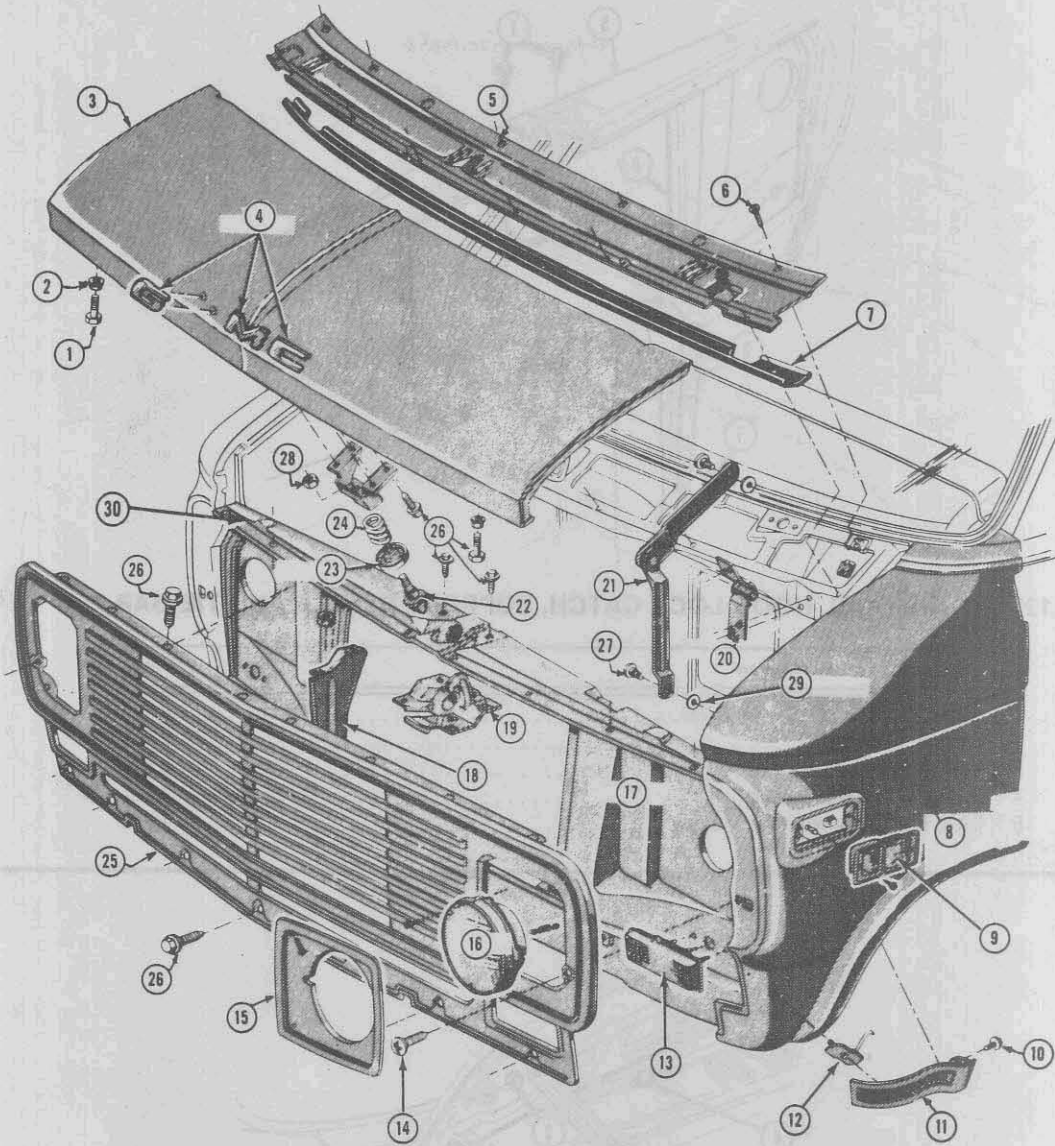

1971-75 G-MODELS — HOOD, GRILLE AND FENDERS

Key	Description	Group
1	BUMPER, Hood Panel Front	8.024
2	NUT, Hex. $\frac{5}{16}$ - 18	8.917
3	PANEL, Hood	8.000
4	LETTER, Front End Panel	8.055
5	PANEL, Cowl Top	16.125
6	SCREW, Oval Hd. #10 - 16 x $\frac{3}{4}$	8.977
7	SEAL, Cowl Hood Ledge	8.010
8	FENDER, Front	8.130
9	LAMP, Marker — Front	2.575
10	SCREW, Pan Hd. #8 - 18 x $\frac{3}{8}$	8.977
11	MOULDING UNIT, Front Fender	8.132
12	RETAINER, Front Fender Side Moulding	8.133
13	LAMP, Parking	2.585
14	SCREW, Pan Hd. Cr. Rec. $\frac{1}{4}$ - 14 x $\frac{3}{4}$	8.977
15	BEZEL, Headlamp	2.728

Key	Description	Group
16	HEADLAMP	2.724
17	BAFFLE, Radiator Support	1.270
18	SUPPORT, Hood Lock	8.080
19	LATCH, Hood	8.080
20	HINGE, Hood	8.015
21	ROD, Hood Support	8.015
22	BOLT, Hood Lock	8.085
23	RETAINER, Hood Lock Bolt Spring	8.085
24	SPRING, Hood Lock Bolt	8.085
25	GRILLE, Radiator	1.266
26	BOLT, Hex. Hd. $\frac{3}{16}$ - 18 x $\frac{7}{8}$	8.900
27	SCREW, Hood Support Rod	8.016
28	PLATE, Hood Latch Bolt Mounting	8.080
29	WASHER, Hood Support Rod	8.016
30	BAR, Radiator Support Tie — Upper	1.270

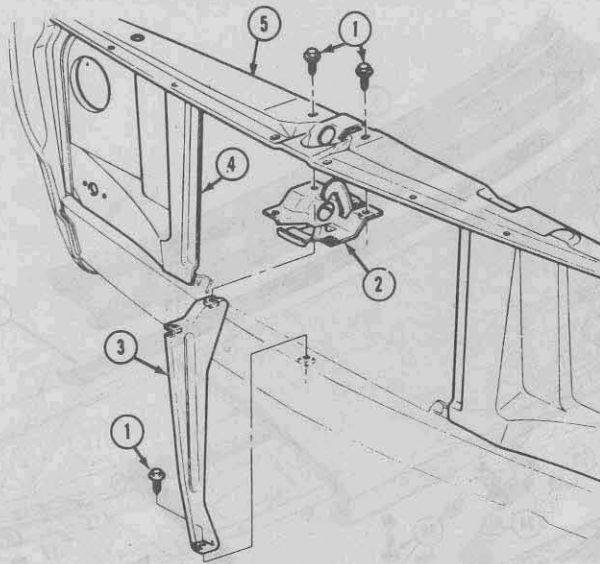

1971-75 G-MODEL HOOD LOCK CATCH, SUPPORT BAFFLE AND TIE BAR

Key	Description	Group
1	BOLT, Hex. HD. (5/16 - 18 x 7/8)	8.900
2	CATCH, Hood Lock	8.083
3	SUPPORT, Hood Lock	8.080
4	BAFFLE, Radiator Support	1.270
5	BAR, Radiator Support Tie - Upper	1.270

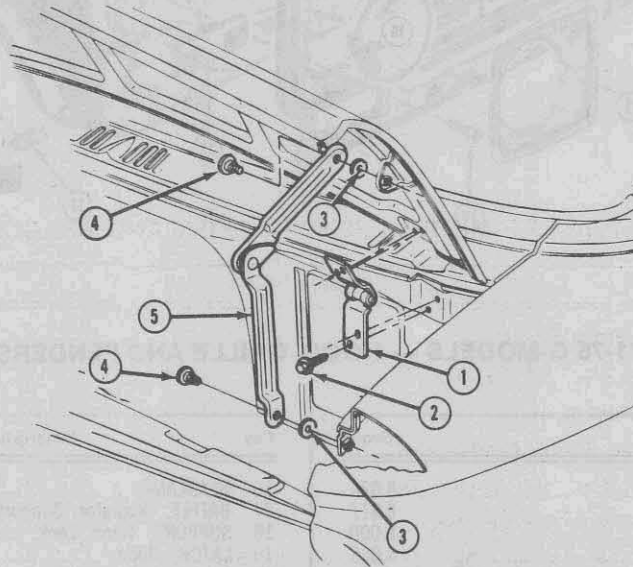

1971-75 G-MODEL HOOD HINGE AND SUPPORT

Key	Description	Group
1	HINGE, Hood	8.015
2	BOLT, Hexagon Head (5/16 - 18 x 5/8)	8.900
3	WASHER, Hood Support Rod - Spline	8.015
4	SCREW, Hood Support Rod - To Hood Or Fender	8.016
5	ROD, Hood Support	8.015

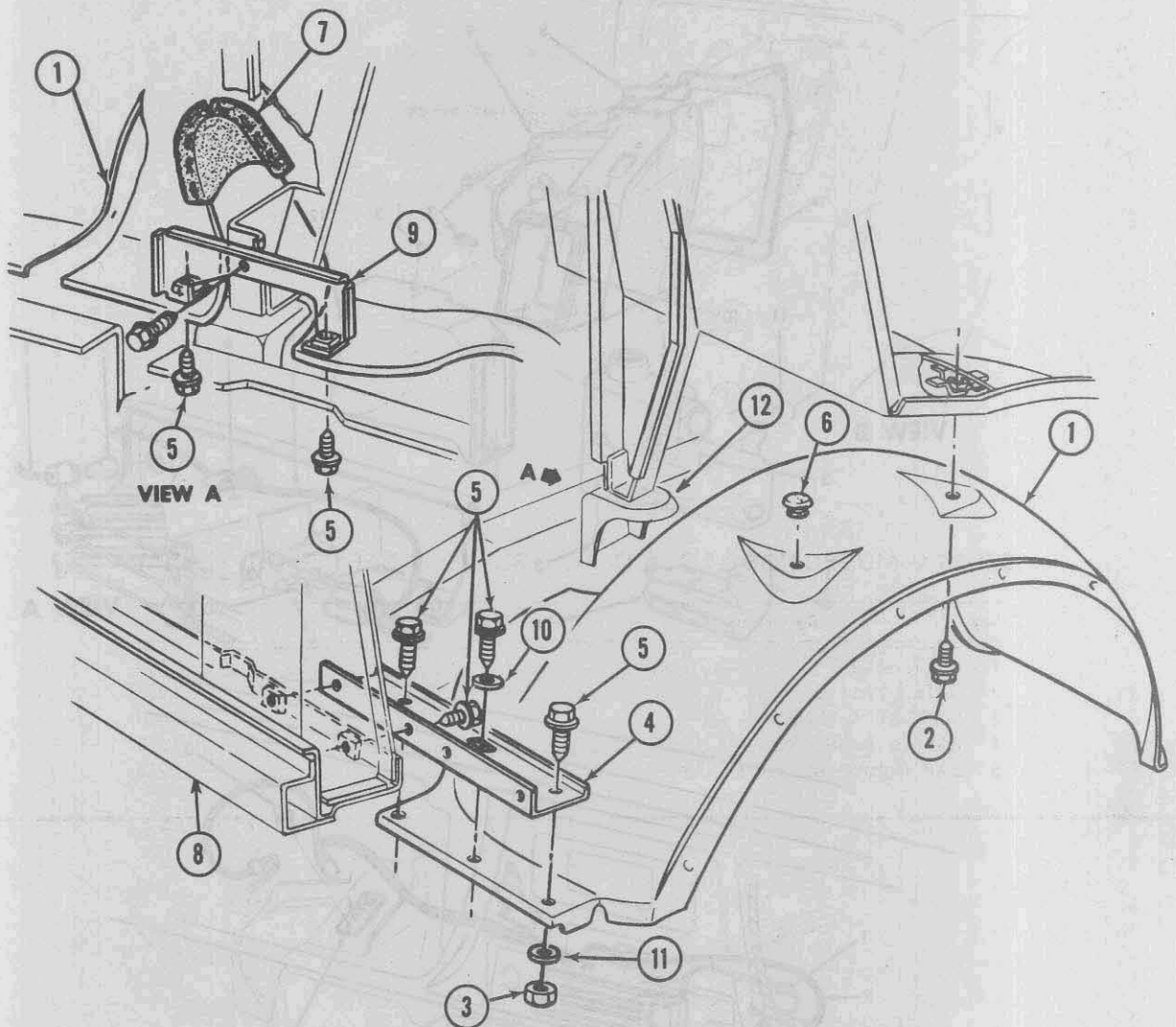

1974-75 P-MODELS FENDER SKIRT AND BRACKET

Key	Description	Group
1	Skirt, Front Fender	8.153
2	Screw, Hex. Hd. $\frac{5}{16}$ -18 x $\frac{5}{8}$	8.977
3	Nut, Hex. $\frac{5}{16}$ -18	8.915
4	Bracket, Front Fender Skirt	8.155
5	Screw, Hex. Hd. $\frac{5}{16}$ -18 x $\frac{7}{8}$	8.977
6	Plug, Front Fender Skirt	8.153
7	Seal, Front Fender Skirt to Steering Column	8.154
8	Support, Radiator	1.270
9	Brace, Front Fender Skirt to Steering Column	8.155
10	Washer, Flat $\frac{5}{16}$ ID x 1 OD	8.929
11	Washer, Flat $\frac{1}{32}$ ID x $\frac{5}{8}$ OD	8.929
12	Bracket, Radiator Support	1.270

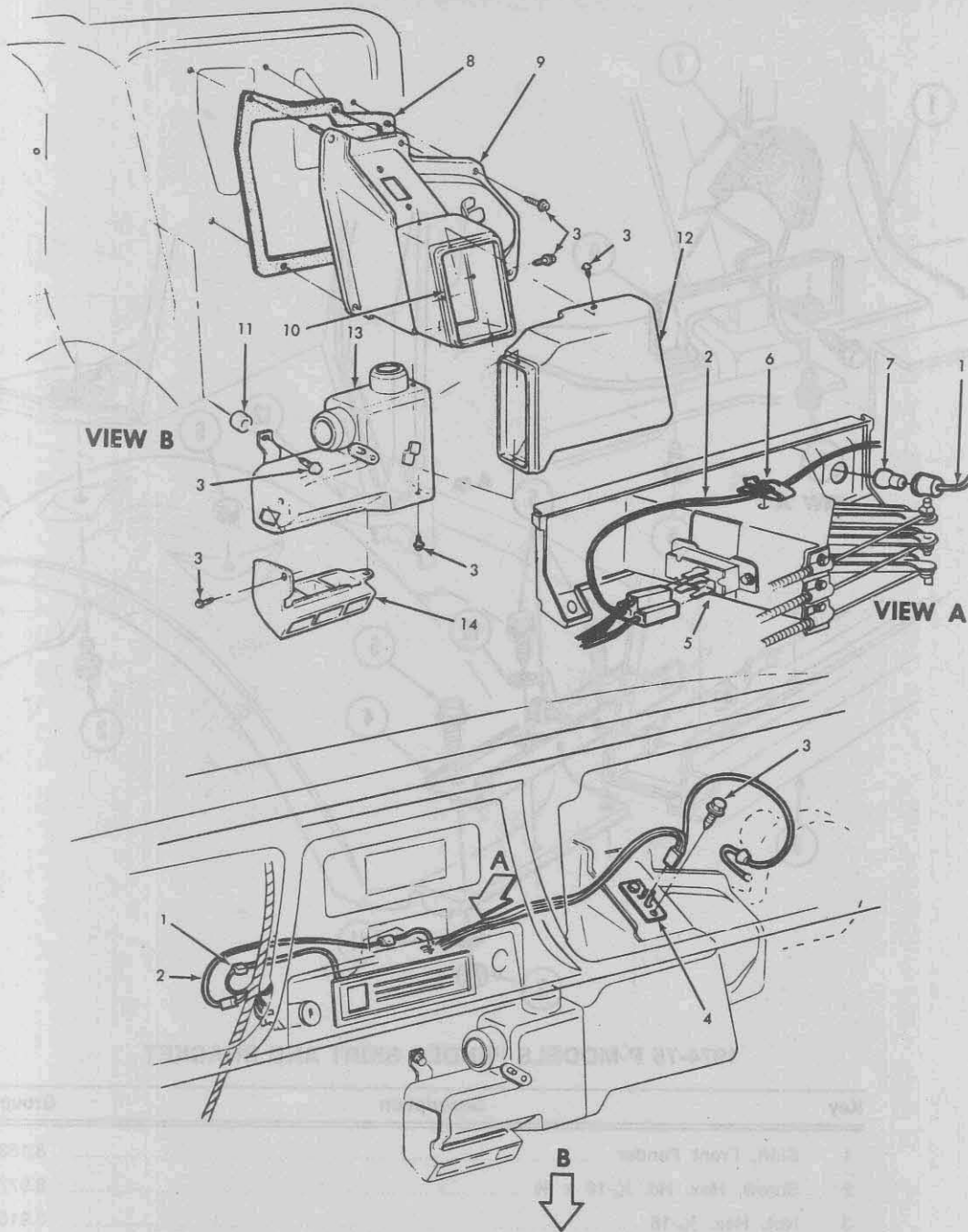

1967-73 HEATER WIRING, DISTRIBUTOR AND DUCTS

Key	Description	Group
1	MAKE LOCALLY—Use 20 Gauge Wire	N.S.
2	WIRE, Heater Control	8.852
3	SCREW	8.977
4	RESISTOR, Heater Blower	8.855
5	SWITCH, Heater Blower Control	8.852
6	CLIP—For ¼ Hole	8.950
7	BULB	8.991

Key	Description	Group
8	GASKET, Air Distributor Adapter	9.786
9	ADAPTER, Air Distributor	9.786
10	EXTENSION, Heater Air Distributor	9.786
11	WASHER, Heater Duct	8.845
12	DISTRIBUTOR, Heater Air	9.786
13	DUCT, Heater to Air Distributor	9.786
14	OUTLET, Heater Air Distributor	9.779

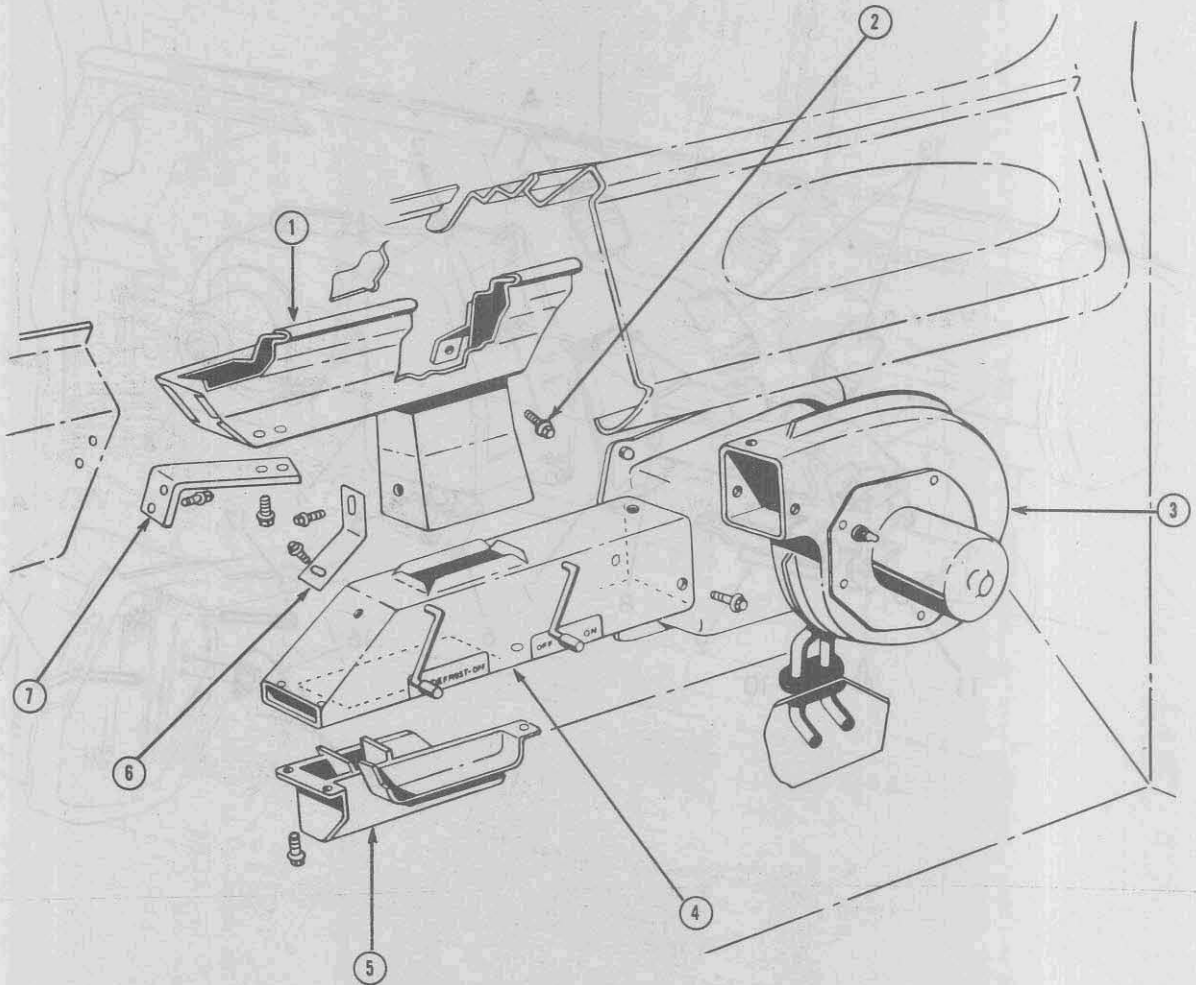

1965-66 G10-G910 HEATER AND DEFROSTER DISTRIBUTOR ASSEMBLY

KEY	DESCRIPTION	GROUP
1	Duct, Heater and Defroster	9.786
2	Screw — #8 — 18 x 1/2	N.S.
3	Case, Heater Core and Blower	8.857
4	Distributor, Heater and Defroster Air	9.786

KEY	DESCRIPTION	GROUP
5	Outlet, Heater and Defroster Air Distributor	9.779
6	Bracket, Heater and Defroster Air Distributor	9.786
7	Bracket, Duct to Wiper Support	8.845
NS	— Not Serviced	

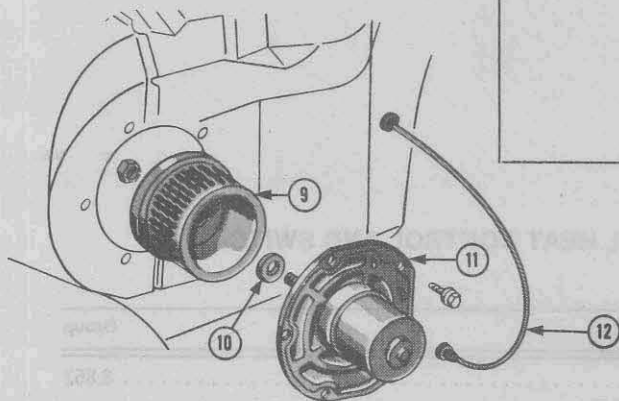
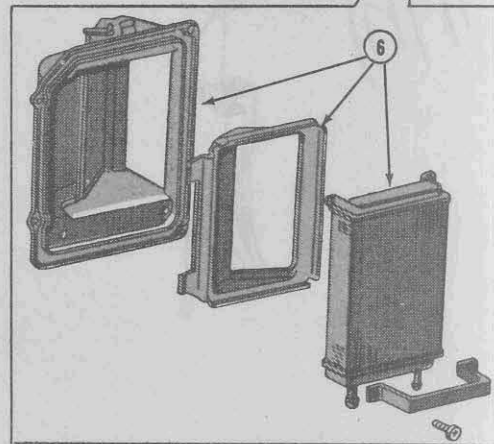
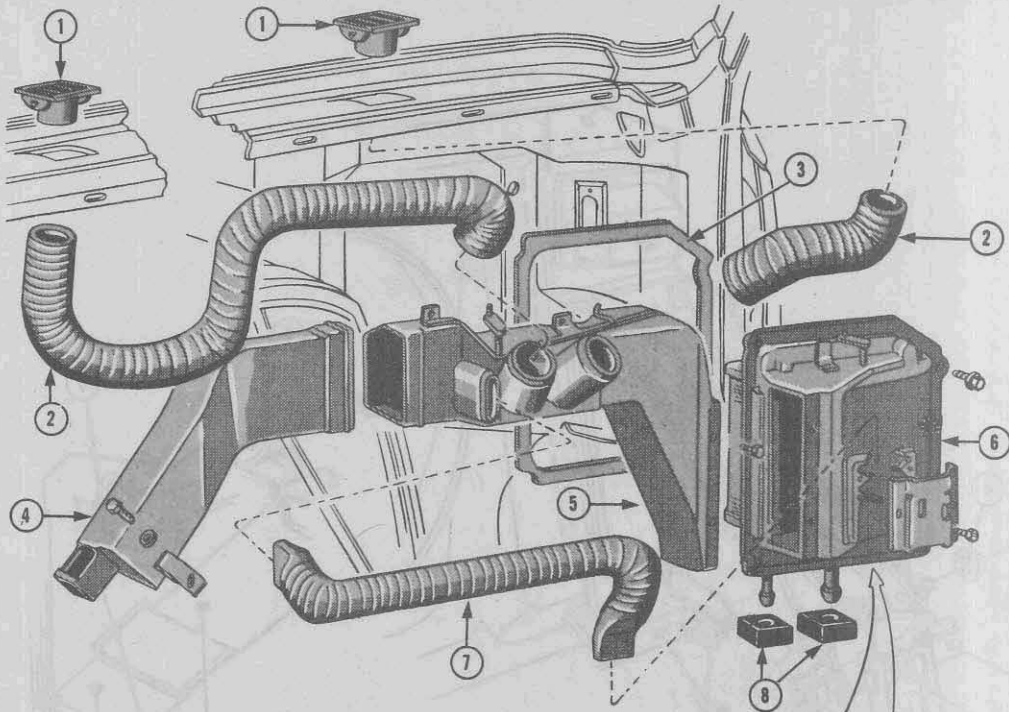

1971-75 G-MODEL HEATER AND DUCT

Key	Description	Group
1	INLET, Heater and Defroster.....	9.779
2	HOSE, Defroster Outlet	9.779
3	GASKET, Heater Case	9.211
4	DUCT, Heater To Air Distributor Outlet	9.786
5	DISTRIBUTOR, Heater And Defroster Air.....	9.786
6	CASE, Heater - Inc. Core	8.854

Key	Description	Group
7	HOSE, Defroster	9.779
8	PAD, Heater Core Support	8.854
9	FAN, Heater	8.857
10	WASHER, Heater Blower Motor	8.857
11	MOTOR, Heater Blower.....	8.855
12	WIRE, Heater Control	8.853

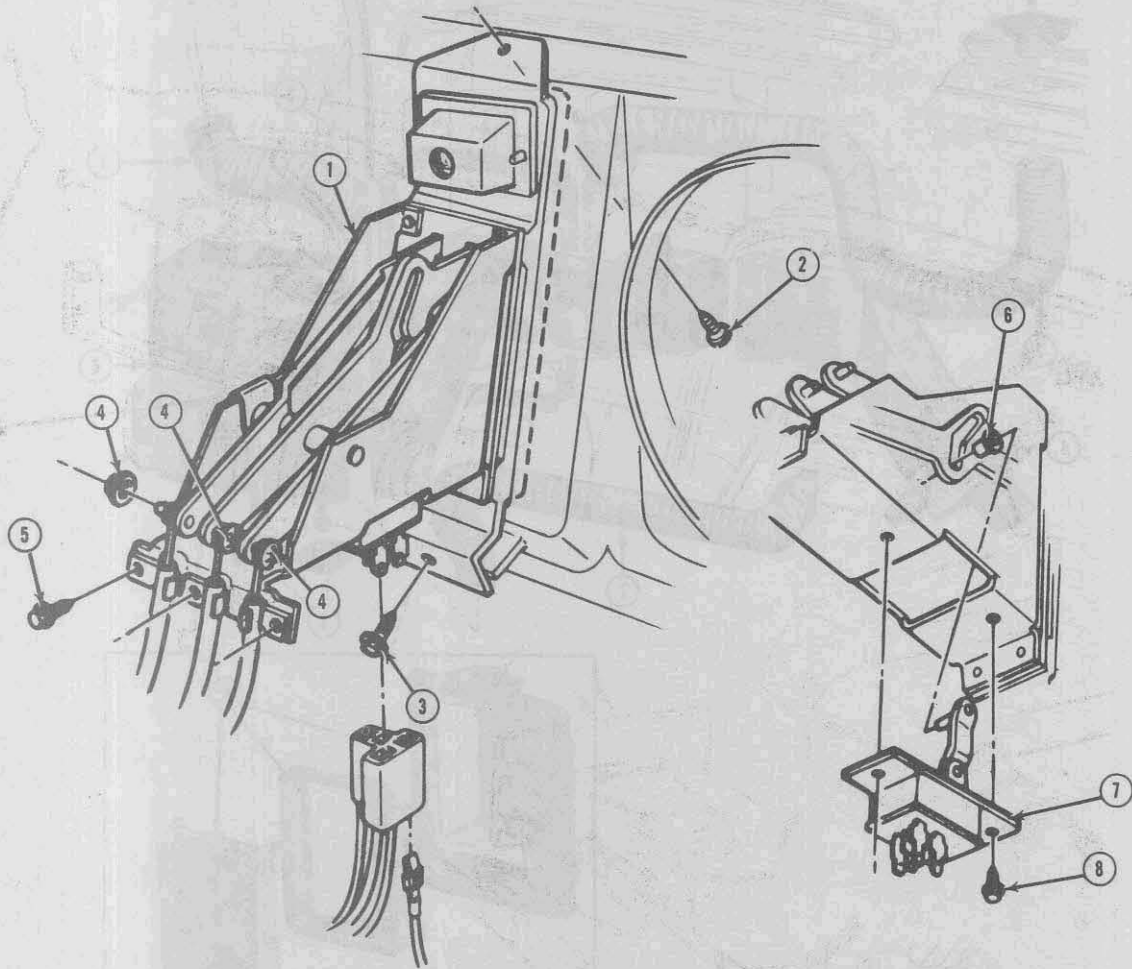

1971-73 G-MODEL HEAT CONTROL AND SWITCH

Key	Description	Group
1	CONTROL, Heater	8.852
2	SCREW, Oval HD. CR. Rec. Tapping #8 - 18 x 1/2	8.977
3	SCREW, Hex. Washer HD. Tapping #10 - 16 x 1/2	8.977
4	NUT, Push-on Spring - Round	8.921
5	SCREW, Hex. Washer HD. Tapping #10 - 16 x 5/8	8.977
6	BUSHING, Heater Control Switch	8.852
7	SWITCH, Heater Blower Control	8.852
8	SCREW, Hex. Washer HD. Tapping #8 - 18 x 3/8	8.977

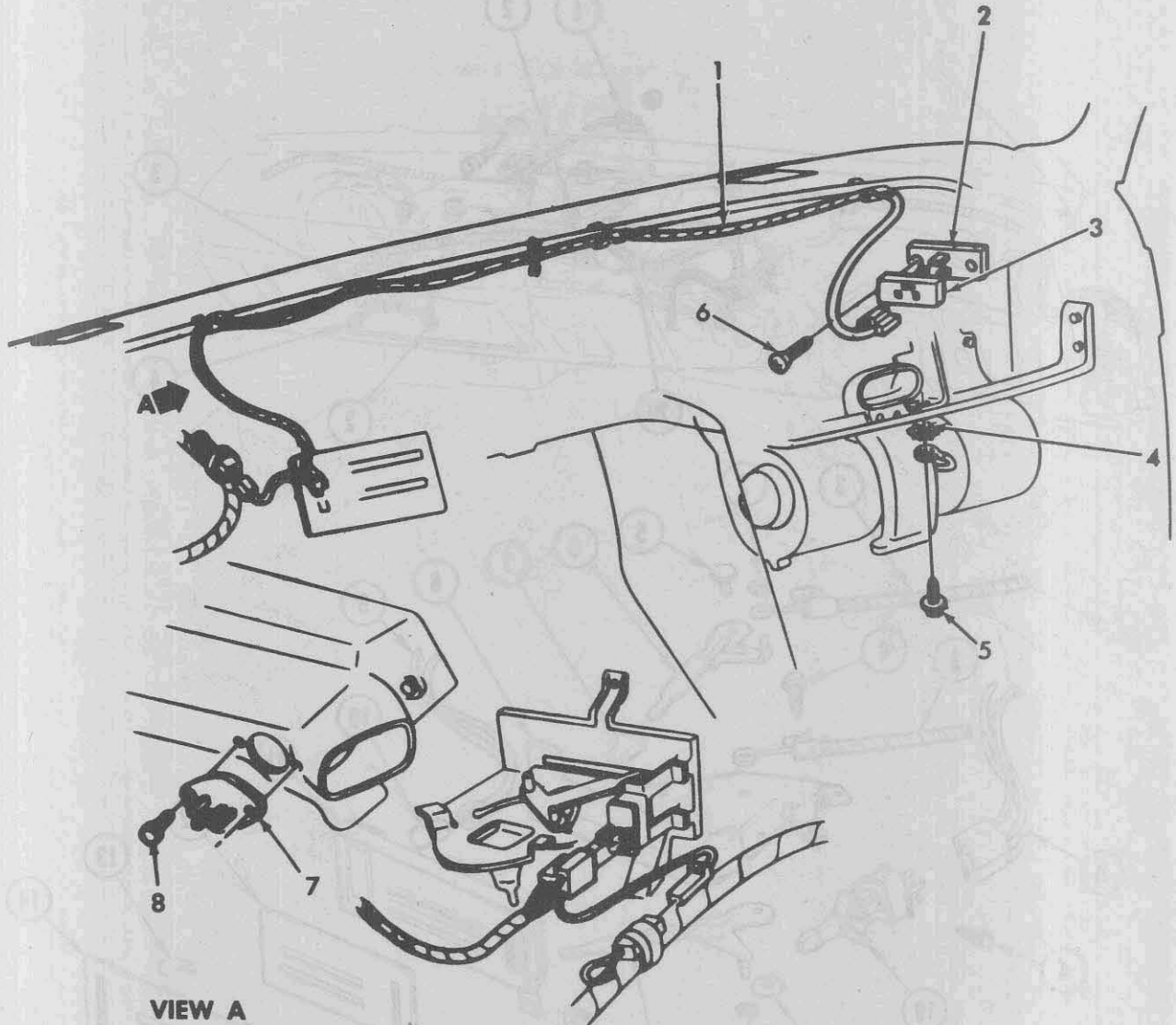

VIEW A

1974-75 G-MODELS HEATER CONTROL

Key	Description	Group
1	WIRE, Heater Control	8.853
2	RESISTOR, Heater Blower	8.855
3	SEAL, Heater Blower Motor Resistor	8.855
4	WASHER, External Tooth Lock (1/4 I.D. x 1/2 O.D.)	8.932
5	SCREW, Hex (1/4-14 x 1/2)	8.917
6	SCREW, Hex Tap (10-16 x 1/2)	8.977
7	RESISTOR, A/C Blower	9.275
8	SCREW, Hex (10-16 x 1/2)	8.939
9	CONTROL, Heater and/or A/C	8.852

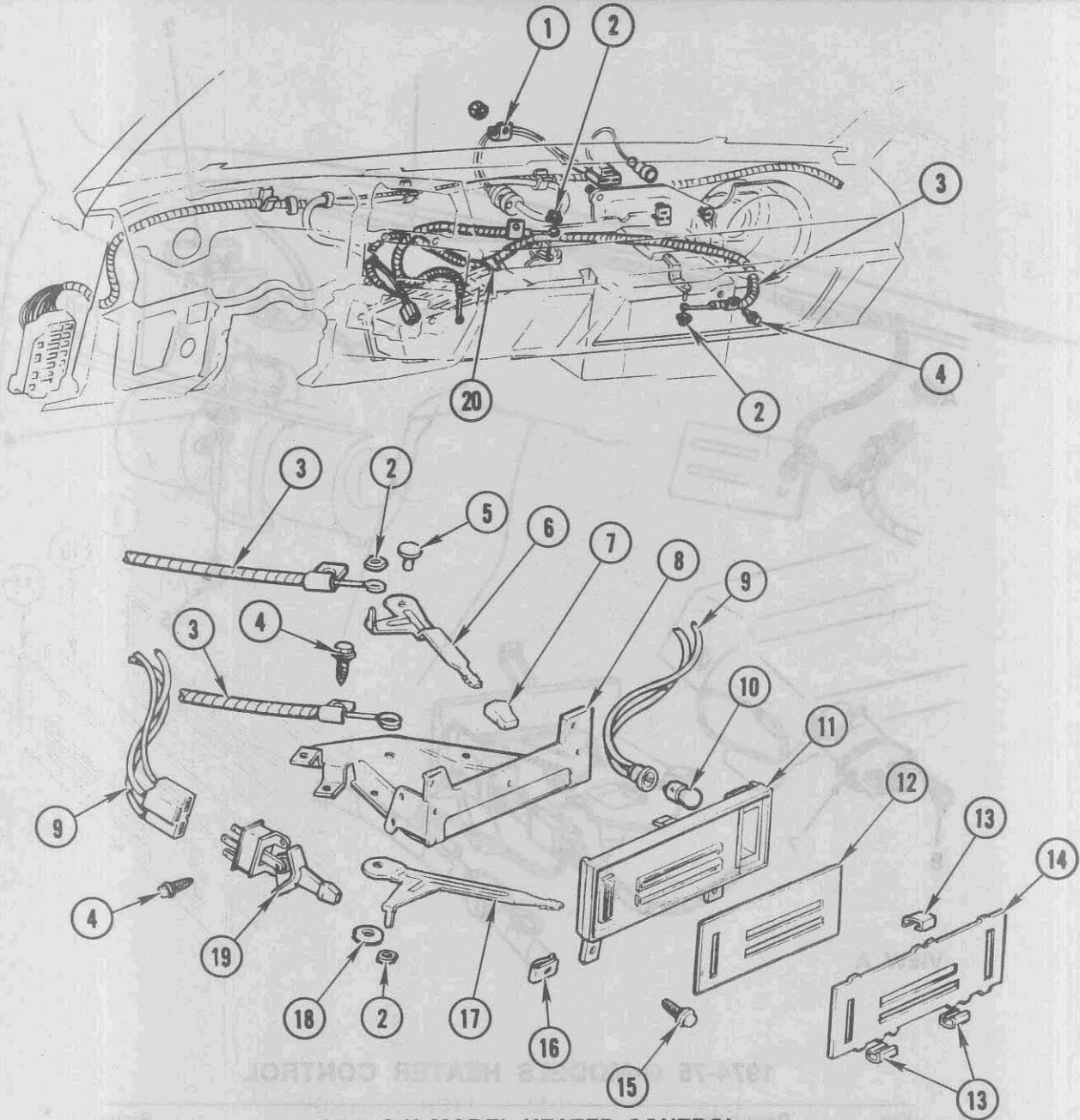

1973 C-K MODEL HEATER CONTROL

Key	Description	Group	Key	Description	Group
1	CLIP, Semi Closed	8.921	11	BACK PLATE, Heater Control — Part of Control Asm.	N.S.
2	NUT, Heater Control Cable	9.787	12	INSERT, Heater Control — Part of Control Asm.	N.S.
3	CABLE UNIT, Flexible Control Replacement	9.787	13	SPRING, Heater Control	8.852
4	SCREW, Hexagon Head 18 x 12	8.977	14	LENS, Heater Control Light	8.852
5	RIVET, Heater Control — Part of Control Asm.	N.S.	15	SCREW, Hexagon Head 10 x 18	8.977
6	LEVER, Heater Control — Part of Control Asm.	N.S.	16	NUT, Closed Type 8 x 18	8.921
7	KNOB, Heater and Air Conditioning	8.852	17	LEVER, Temperature Control — Part of Control Asm.	N.S.
8	PLATE, Heater Control Assembly — Part of Control Asm.	N.S.	18	WASHER, Flat Type	8.931
9	WIRE, Heater Control — Wiring Harness	8.853	19	SWITCH, Heater Blower Control	8.852
10	BULBS, Lamp	8.991	20	CLIP, Heater and Vacuum Hose	8.950

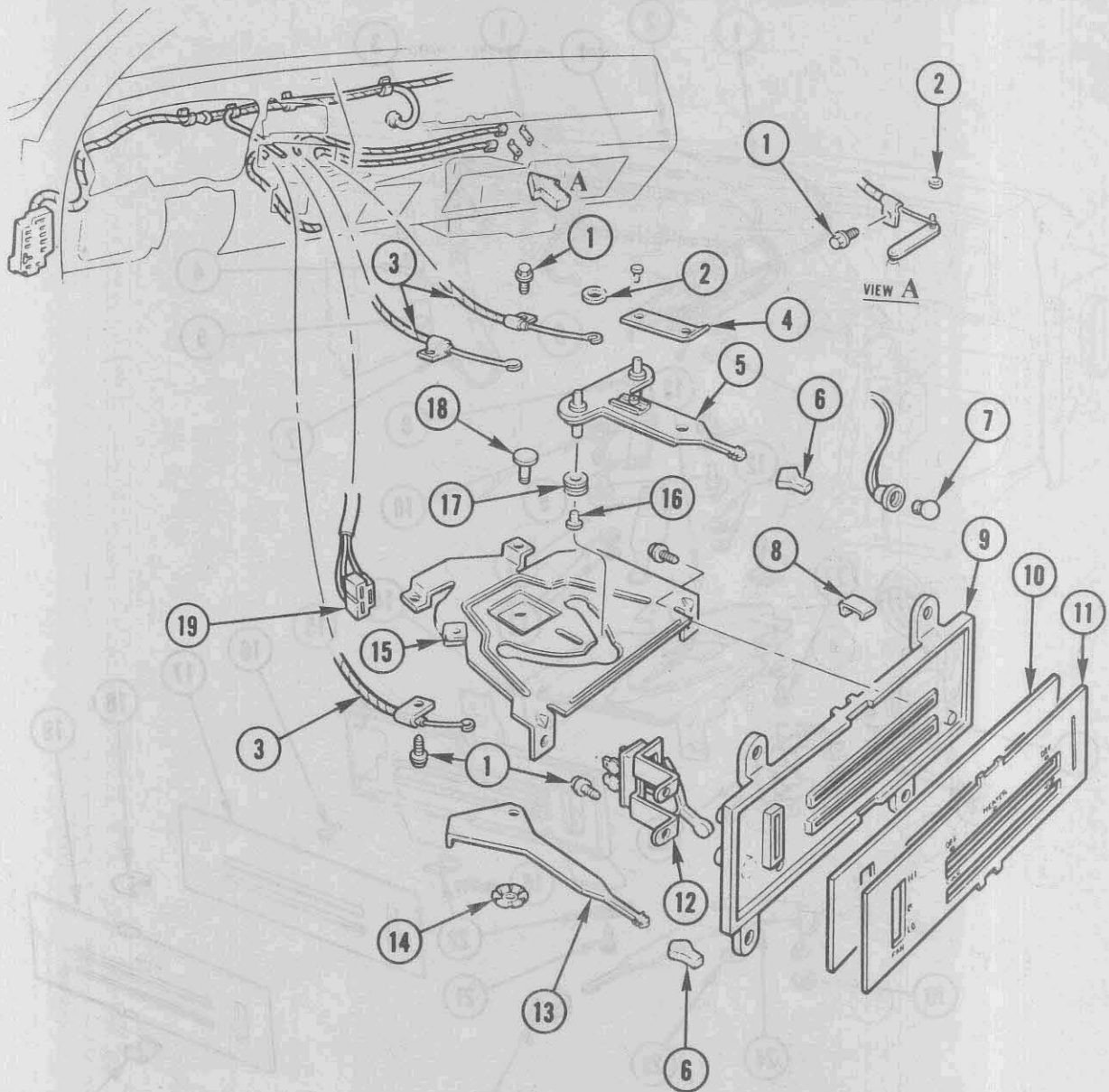

1974-75 C-K MODEL HEATER CONTROL

Key	Description	Group
1	SCREW, Hexagon Head 1/4-14 x 5/8	8.977
2	WASHER, Spring Type	8.931
3	CABLE UNIT, Flexible Control Replacement	9.787
4	PLATE, Heater Control — Part of Control Asm.	N.S.
5	LEVER ASSEMBLY, Heater Control — Part of Control Asm.	N.S.
6	KNOB, Heater and Air Conditioning	8.852
7	BULBS, Lamp	8.991
8	BRACKET, Heater Control Plate — Part of Control Asm.	N.S.
9	PLATE, Heater Control	8.852
10	INSERT, Heater Control Lens	8.852

Key	Description	Group
11	LENS, Heater Control Light	8.852
12	SWITCH, Heater Blower Control	8.852
13	LEVER ASSEMBLY, Heater Control — Part of Control Asm.	N.S.
14	FASTENER, Lever Assembly — Part of Control Asm.	N.S.
15	PLATE, Heater Control — Part of Control Asm.	N.S.
16	RIVET, Heater Control — Part of Control Asm.	N.S.
17	WHEEL, Heater Control — Part of Control Asm.	N.S.
18	RIVET, Heater Control — Part of Control Asm.	N.S.
19	HARNES, Instrument Panel Wiring	2.480

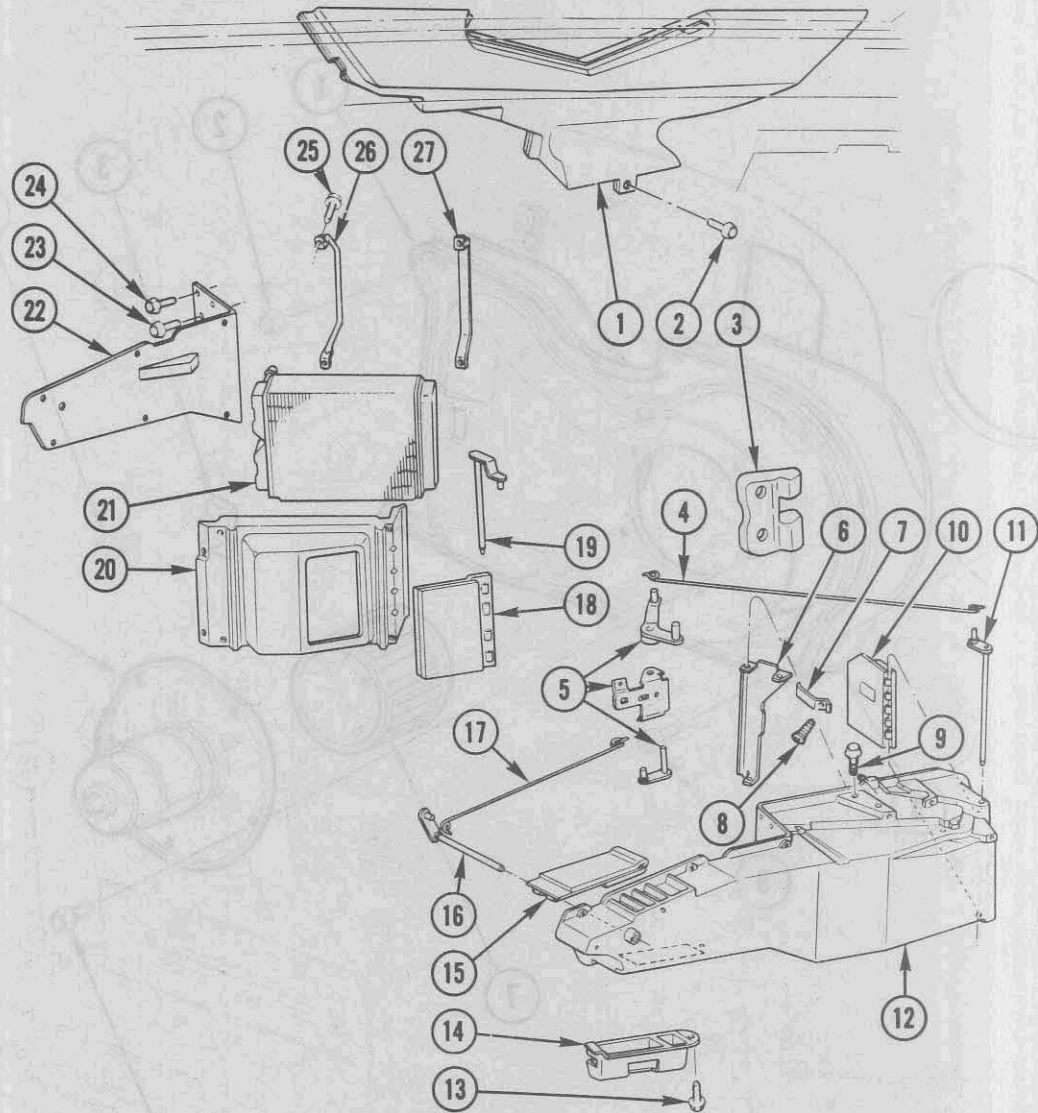

1973 C-K MODEL HEATER AND DEFROSTER ASSEMBLY

Key	Description	Group	Key	Description	Group
1	OUTLET, Heater and Defroster	9.779	15	VALVE, Heater — Heater Defroster Valve	9.786
2	BOLT, 10-16 x 1/2	8.900	16	SHAFT, Heater Valve	9.786
3	SEAL, Heater Core Pipe	8.854	17	LINK, Heater and Defroster	9.786
4	LINK, Heater and Defroster	9.786	18	VALVE, Heater — Temperature Valve and Seal	9.786
5	BRACKET, Heater and Defroster	9.786	19	SHAFT, Heater Valve — Temperature Valve Shaft	9.786
6	SEAT, Heater Purge Valve	8.854	20	SHROUD, Heater Core	8.854
7	Part of Key 12	N.S.	21	CORE AND FITTING, Heater	8.854
8	SCREW, 8-18 x 3/4	8.977	22	Part of Key 12	N.S.
9	BOLT, 8-18 x 3/8	8.900	23	BOLT, 10-16 x 1/2	8.977
10	VALVE, Heater	9.786	24	BOLT, 10-18 x 3/4	8.977
11	SHAFT, Heater Valve	9.786	25	BOLT, 8-18 x 3/8	8.900
12	CASE, Heater	8.854	26	CLAMP, Heater Core Mounting — In-Out Tank	8.854
13	SCREW, Hexagon 10-16 x 3/4	8.977	27	CLAMP, Heater Core Mounting	8.854
14	OUTLET, Heater and Defroster Air Distributor	9.779			

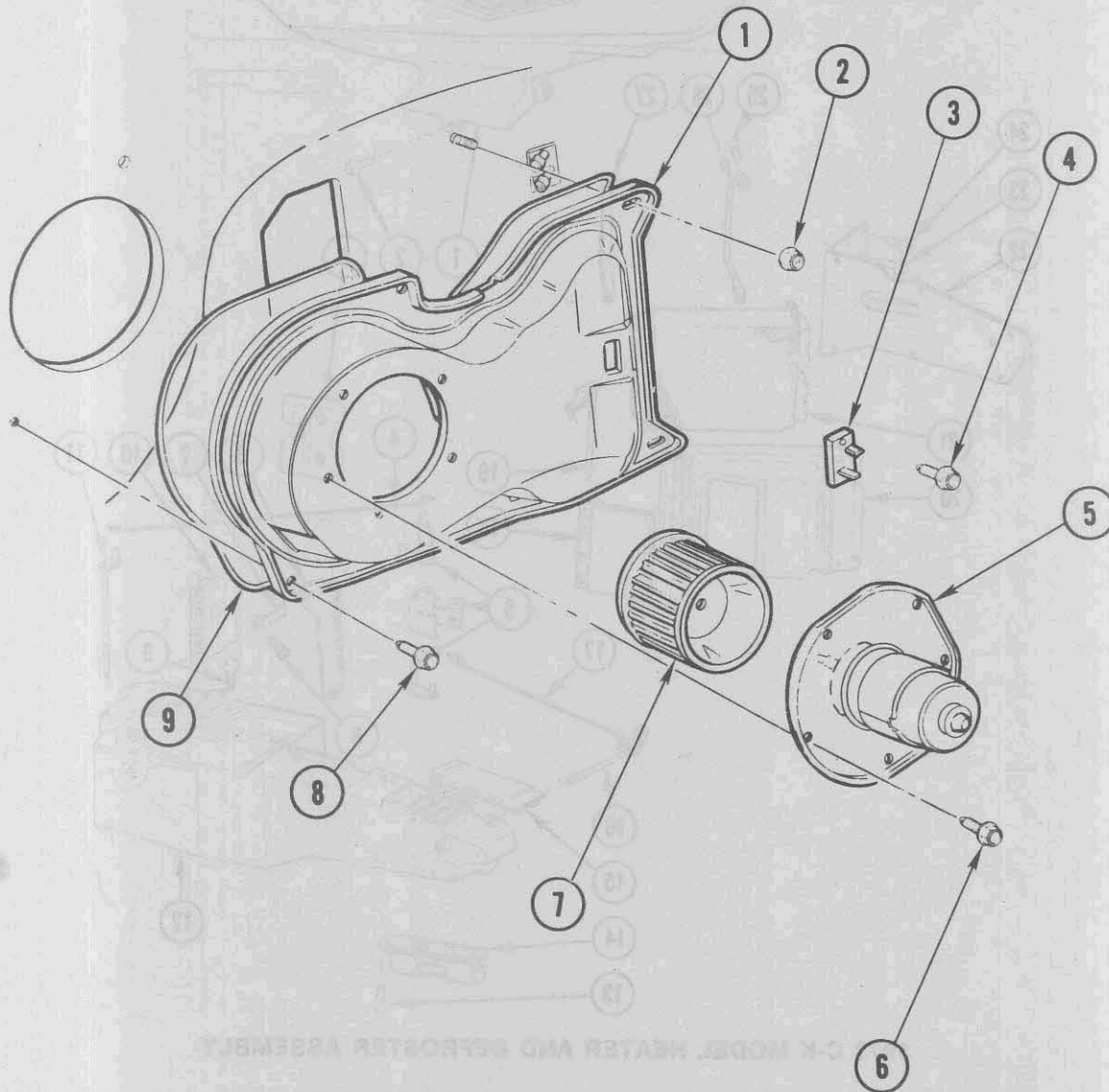

1973-75 C-K MODEL — HEATER BLOWER AND AIR INLET ASM.

Key	Description	Group
1	BLOWER, Heater and Defroster — Blower and Air Inlet	8.857
2	NUT, 1/4-20	8.921
3	RESISTOR, Heater Blower	8.855
4	SCREW, 1/4-14 x 1	8.977
5	MOTOR, Heater Blower	8.855

Key	Description	Group
6	SCREW, 1/4-20 x 1	8.977
7	FAN, Heater	8.857
8	SCREW, 1/4-14 x 1	8.977
9	SEALER, Blower to Dash	N.S.

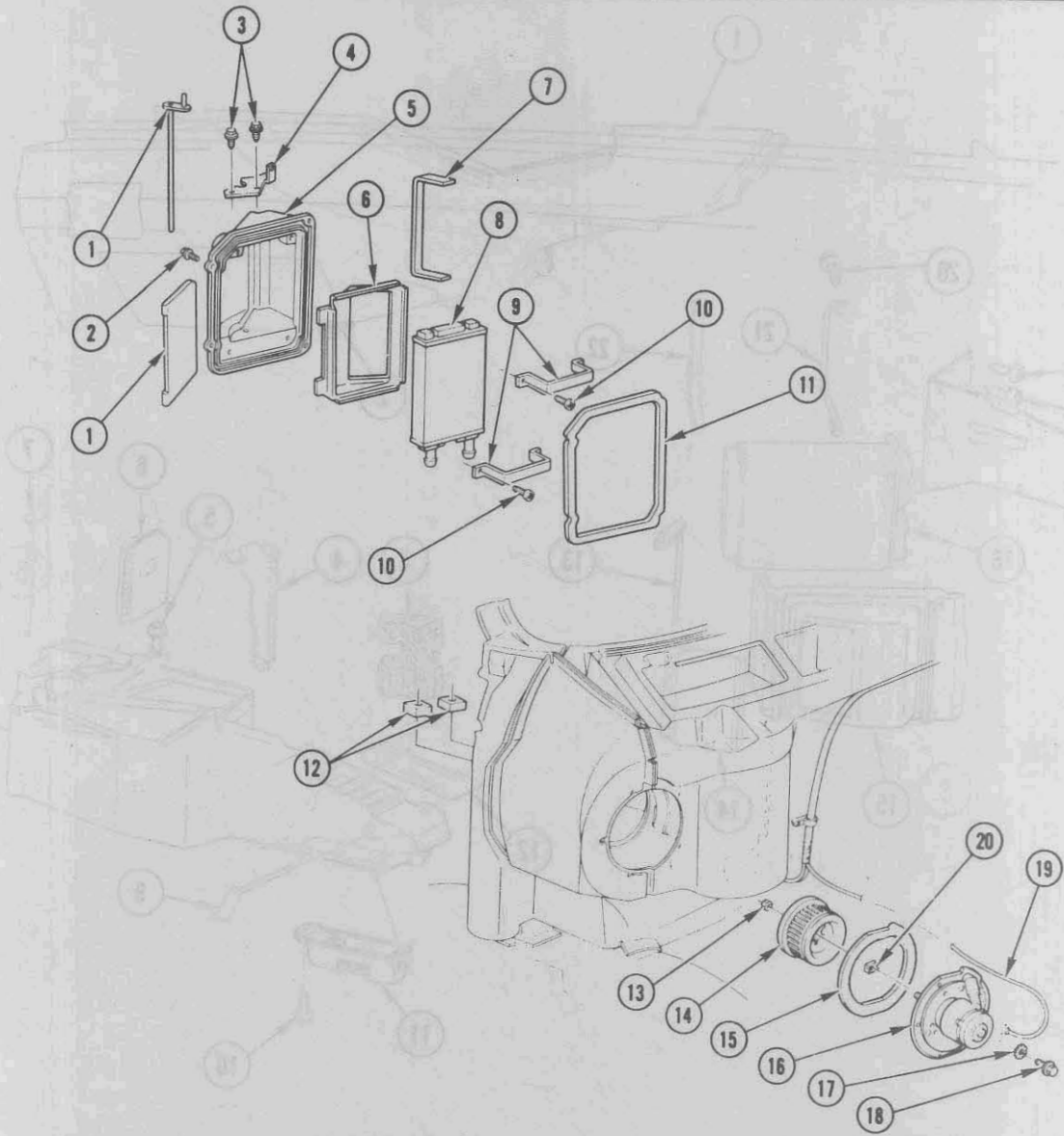

1973-75 G-MODEL HEATER AND BLOWER ASSEMBLY

Key	Description	Group
1	VALVE ASSEMBLY — Part of Key 5	N.S.
2	SCREW — Part of Key 5	N.S.
3	SCREW — Part of Key 5	N.S.
4	BRACKET — Part of Key 5	N.S.
5	CASE, Heater	8.854
6	SEAT, Heater Core	N.S.
7	SEAL, Air Conditioning — Heater Case and Core Seal	9.211
8	CORE AND FITTING, Heater	8.854
9	BRACKET, Heater Core	N.S.
10	SCREW	8.906

Key	Description	Group
11	GASKET, Heater — Heater Case	8.854
12	PAD, Heater Core	N.S.
13	NUT, Heater Fan	8.858
14	FAN, Blower Motor	N.S.
15	SEALER, Blower Motor	N.S.
16	MOTOR, Heater Blower	8.855
17	WASHER — 10 External Teeth	8.932
18	SCREW, Hexagon 8-18 x 1/2	8.977
19	HARNES, Engine Wiring	2.525
20	WASHER, Heater Blower Motor	8.857

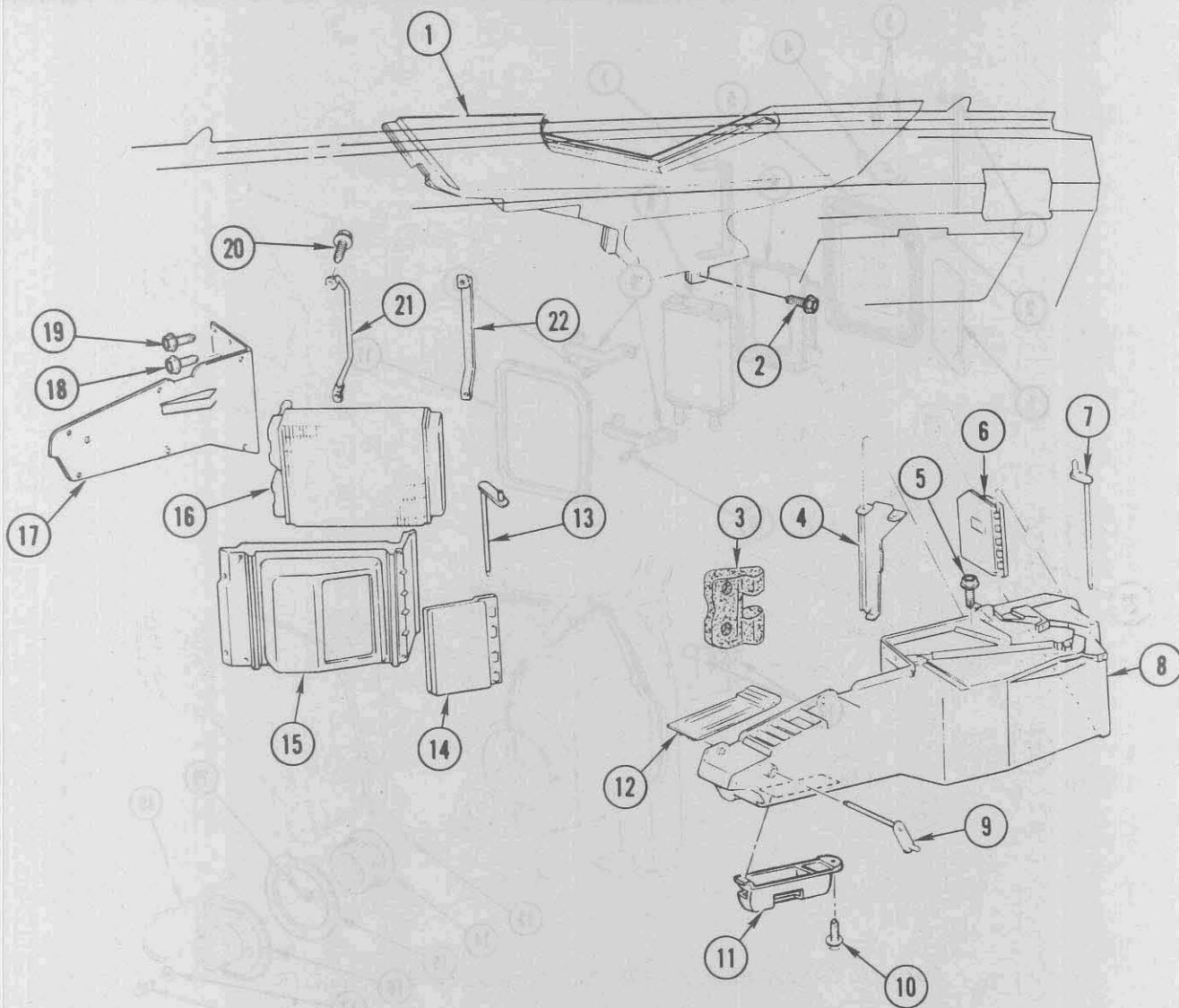

1973-75 G-MODEL HEATER CONTROLS

Key	Description	Group
1	OUTLET, Heater and Defroster	9.779
2	SCREW, Hexagon 10-16 x 3/4	8.977
3	SEAL, Heater Core Pipe	8.854
4	SEAT, Heater Purge Valve	8.854
5	BOLT, 8-18 x 3/8	8.900
6	VALVE, Heater — Defroster Purge Valve and Seal	9.786
7	SHAFT, Heater Valve — Purge Valve Shaft	9.786
8	CASE, Heater	8.854
9	SHAFT, Heater Valve — Defroster Shaft and Lever	9.786
10	SCREW, Hexagon 10-16 x 3/4	8.977
11	OUTLET, Heater and Defroster Air Distributor	9.779

Key	Description	Group
12	VALVE, Heater — Defroster Valve	9.786
13	SHAFT, Heater Valve — Temp. Valve Shaft	9.786
14	VALVE, Heater — Temp. Valve and Seal	9.786
15	SHROUD, Heater Core	8.854
16	CORE AND FITTING, Heater	8.854
17	PLATE AND BOLT, Heater	8.854
18	BOLT, 10-16 x 1/2	8.977
19	BOLT, 10-18 x 3/4	8.977
20	BOLT, 8-18 x 3/8	8.900
21	CLAMP, Heater Core Mounting — Inlet-Outlet	8.854
22	CLAMP, Heater Core Mounting — Header Tank	8.854

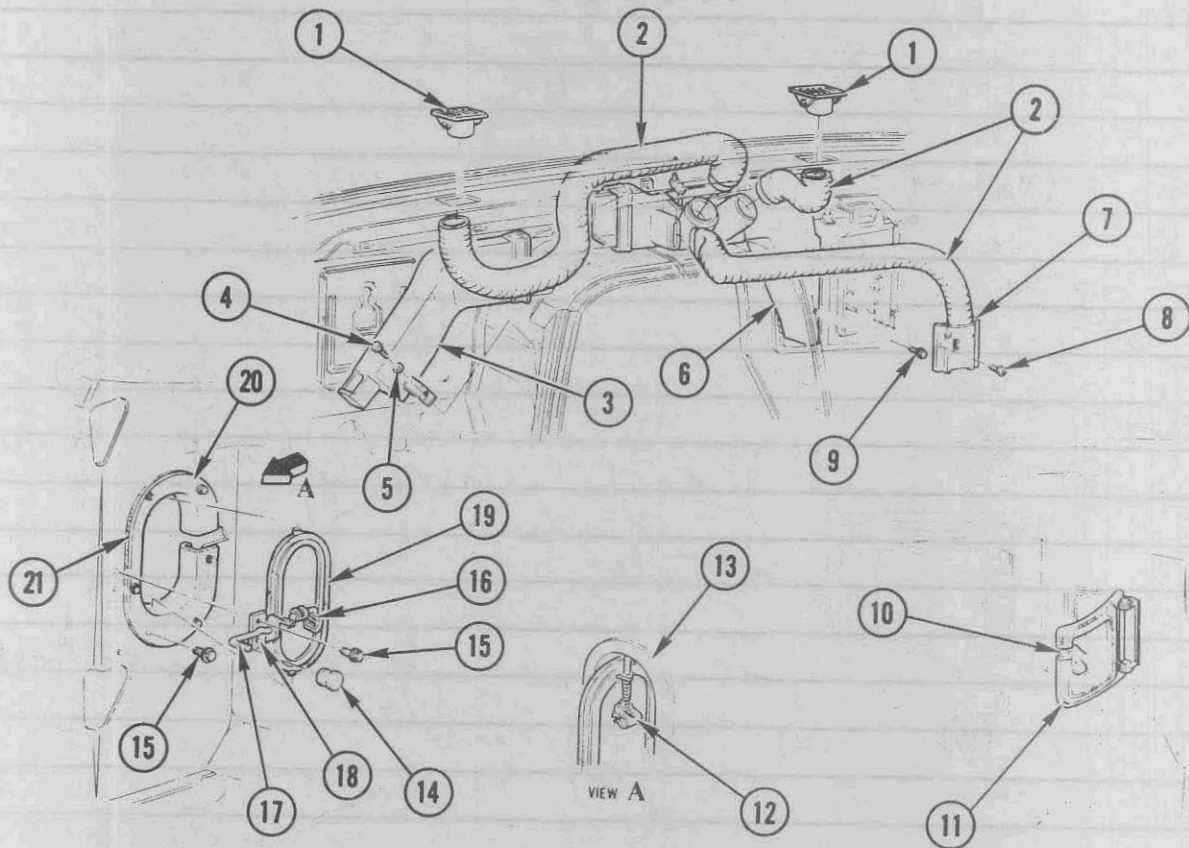

1973-75 G-MODEL HEATER VENTS, HOSES AND DUCTS

Key	Description	Group	Key	Description	Group
1	OUTLET, Heater and Defroster	9.779	12	CLIP, Air Ventilator — Valve Hinge Pin	9.787
2	HOSE, Heater — Heater Air Distributor Hose Inc. Clamp ...	8.846	13	OUTLET, Air Vent Valve	9.789
3	DUCT, Heater to Air Distributor — Outlet	9.786	14	KNOB, Air Vent Valve Operating Rod	9.787
4	BOLT, ¼-20 x ½	8.900	15	SCREW, Hexagon 10-16 x ¾	8.977
5	WASHER, Flat ¼	8.929	16	CLIP, Air Vent Valve	N.S.
6	DISTRIBUTOR, Heater and Defroster Air	9.786	17	ROD, Air Ventilator Control	9.787
7	CLAMP, Heater Air Distributor Hose	9.786	18	GUARD, Air Vent Valve	N.S.
8	SCREW, 8-18 x ¾	8.977	19	VALVE, Air Ventilator	9.789
9	SCREW, 10-16 x ½	8.977	20	VALVE, Air Ventilator	9.789
10	SEAL, Air Ventilator — Door	9.782	21	SEAL, Air Ventilator	9.782
11	DOOR, Air Ventilator	9.789			

